

**1** **LOWER LINK AND BEARINGS**

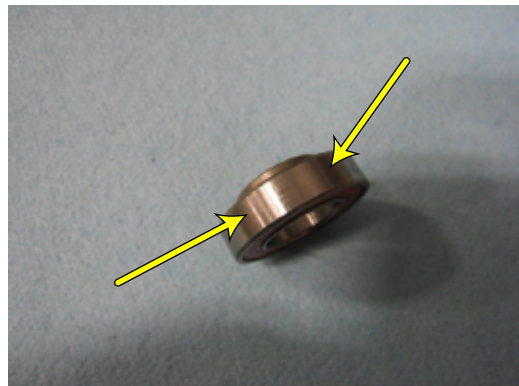

**2** Bearing race must be clean of oil or grease



**3** Bearing pocket must be clean of oil or grease

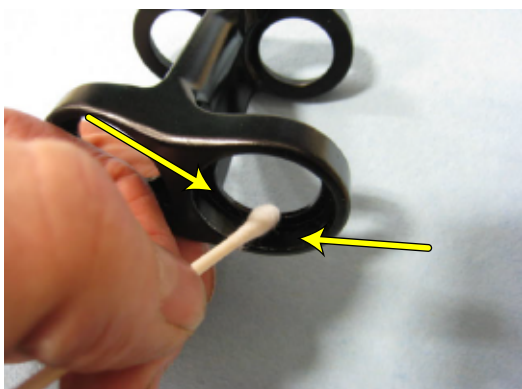

It is best to use alcohol to clean bearings, bearing pockets, and threads to ensure no oil or grease is on any of the surfaces during the assembly process

**4** Apply Loctite 609 or equivalent to all bearing pockets



**5** Use a toothpick to spread the Loctite to coat bearing pocket

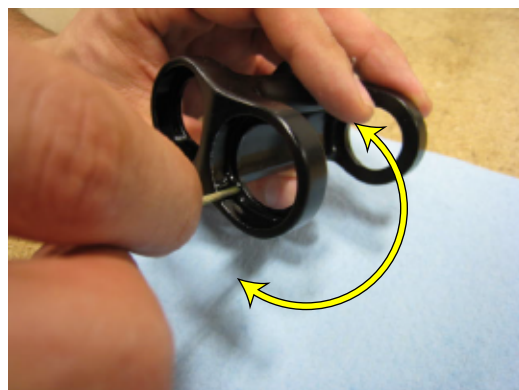

- 6 Use enough Loctite to cover surface until wet

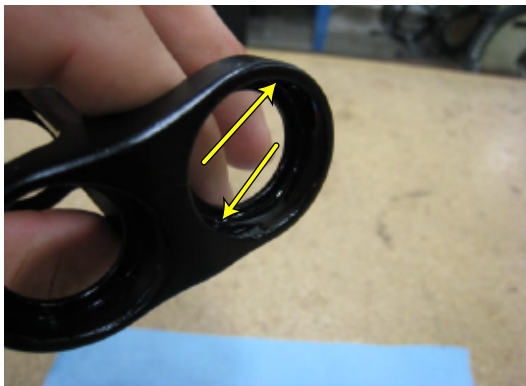

- 7 Press bearings into link



- 8 Apply Loctite 242 or 243 to threads in frame



- 9 Apply enough Loctite to cover threads as shown



- 10 Use a toothpick to spread the Loctite to coat threads

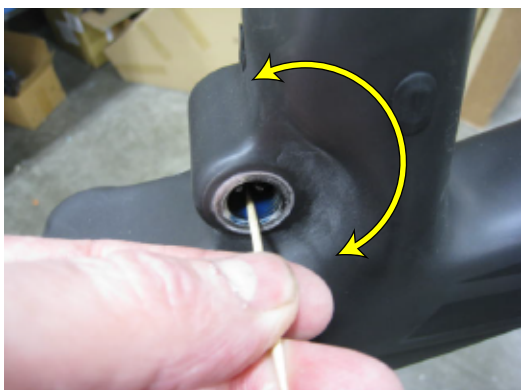

- 11 **DO NOT** apply Loctite on bolt threads



- 12 Install lower link with arrow on NDS facing forward



- 13 Torque bolts to 35Nm



- 14 Check motion of link to ensure free movement





## 15 UPPER LINK AND HARDWARE

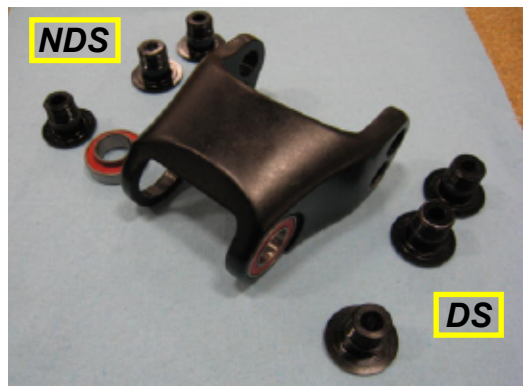

Before installation clean oil and grease off of bearings and link.

It is best to use alcohol to clean bearings, bearing pockets, and threads to ensure no oil or grease is on any of the surfaces during the assembly process

*Follow steps 16-19 only if the DS bearing is not pre-installed*

- 16 Apply Loctite 609 or equivalent to DS bearing pocket only



- 17 Use a toothpick to spread the Loctite to coat bearing pocket



- 18 Use enough Loctite to cover surface until wet

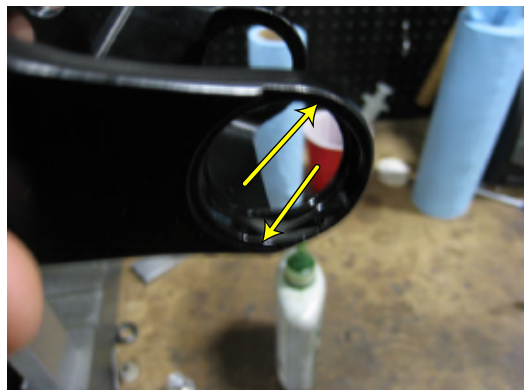

- 19 Install bearing on DS only

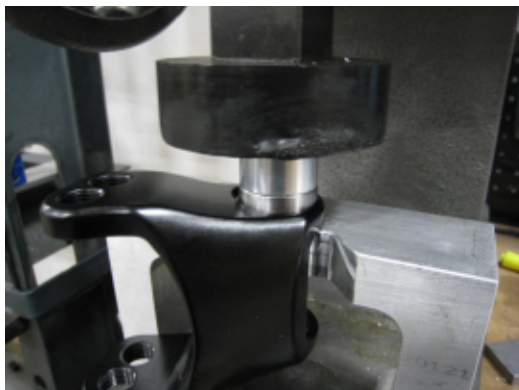

- 20** Apply Loctite 242 or 243 to upper mount threads (both sides)



- 21** Use a toothpick to spread the Loctite to coat threads



- 22** Install bolt in DS



- 23** Torque bolt to 35Nm



- 24** Apply Loctite 609 or equivalent to NDS bearing pocket



- 25** Use a toothpick to spread the Loctite to coat bearing pocket



- 26 Place bolt in bearing  
and install in link



- 27 Torque bolt to 35Nm



- 28 Check motion of link to  
ensure free movement





## 29 CLEVIS AND HARDWARE



Before installation clean oil and grease off of bearings and clevis.

It is best to use alcohol to clean bearings, bearing pockets, and threads to ensure no oil or grease is on any of the surfaces during the assembly process

## 30 Apply Loctite 609 or equivalent to DS bearing pocket only



## 31 Use a toothpick to spread the Loctite to coat bearing pocket



## 32 Use enough Loctite to cover surface until wet



## 33 Install bearing and repeat process for other side

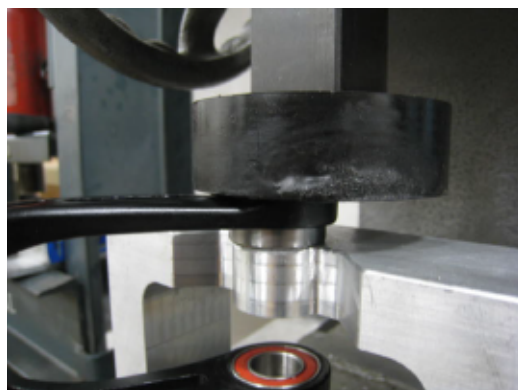

- 34** Apply loctite 243 to all UL threads



- 35** Use a toothpick to spread the Loctite on threads



- 36** Place clevis with threaded side up



- 37** Install bolt in NDS



- 38** Install bolt in DS



- 39** Torque bolts to 35Nm  
*See step 48 for alternate technique*





- 40** Apply Loctite 609 or equivalent to bearing pocket



- 41** Use a toothpick to spread the Loctite on bearing pocket



- 42** Press bearing into upright pockets



- 43** Apply Loctite 242 or 243 to RT threads on both sides



- 44** Use enough Loctite to cover threads as shown



- 45** Use a toothpick to spread the Loctite on threads



- 46** Install RT Bolts



- 47** Torque bolts to 35Nm



- 48** Clevis bolts may be torqued to 35Nm at this time if not done previously



- 49** Install upper bolts in RT



- 50** Torque bolts to 35Nm



- 51** Check motion of assembly to ensure free movement

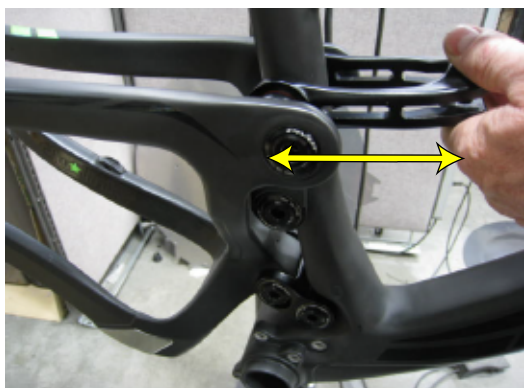

- 52** Apply grease or anti-seize to clevis pin



- 53** Insert pin into shock eye



- 54** Apply grease or anti-seize to clevis bolt



- 55** Install bolt with washer into clevis from bottom



- 56** Twist shock at 45° angle to allow oil canister to clear frame



- 57** Once frame is cleared, align shock vertically in tabs





- 58 Apply grease or anti-seize to shock bolt



- 59 Install shock tab bolt



- 60 Torque shock tab bolt to 13Nm



- 61 Torque clevis bolt to 32Nm

